



MASTERPIECES
MADE IN GERMANY

Flow Monitor

RVM/U-1



OVERVIEW

Operation

- Float measuring principle

Application

- Cooling systems and cooling circuits
- Mechanical engineering
- Pharmaceutical industry
- Chemical industry
- Research & Development

Features

- Universal orientation
- High reliability
- High switch accuracy
- Infinitely variable switch point adjustment by operator
- EX-version according to ATEX directive available
- UL Recognized version available
- High pressure resistance
- Threaded connection, special thread on request

Installation information

- The operating instructions for RVM/U-1 Module BASICS / ...ATEX must be observed!
- **Download: www.meister-flow.com**

RVM/U-1 1 0010 05-16 E M

OPERATING DATA

| | |
|---------------------------------|-----------------------------------|
| Operating pressure, max. | 250 bar (Brass version) |
| | 300 bar (Stainless steel version) |
| Pressure drop | 0,02 – 0,4 bar |
| Temperature, max. | 100 °C (optional 160 °C) |
| Measuring accuracy | ±10 % of full scale |

Changed operating data apply to the device in explosion-proof design according to ATEX directive. Refer to the Operating Instructions for RVM/U-1 Module ATEX.

For UL Recognized devices, changed operating data apply. Refer to the Operating Instructions for RVM/U-1 Module BASICS.

Download: www.meister-flow.com

MEASURING RANGES

| Type | Switch range for H ₂ O at 20 °C ⁽¹⁾ | | |
|-------------|---|-----------|---------|
| | l/min | gph | gpm |
| RVM/U-1/30 | 10 – 30 | 160 – 480 | |
| RVM/U-1/45 | 15 – 45 | 240 – 710 | |
| RVM/U-1/60 | 20 – 60 | 320 – 950 | |
| RVM/U-1/90 | 30 – 90 | | 8 – 24 |
| RVM/U-1/150 | 60 – 150 | | 16 – 40 |

⁽¹⁾ The specified measuring- / switch ranges are valid for water having a density of 1.00 kg/dm³, vertical installation of the device and flow direction from bottom to top.

Other installation positions or deviation from the operating densities will increase the measurement error specified in the data sheet.

Operating density for water at 20 °C and 1.013 bar (absolute value): 1.00 kg/dm³.

Upon request, special scales for deviating media, different operating conditions and installation positions (only for devices which can be installed in any position) are available.

The specified switch values are switch-off points, i.e. switch values by decreasing flow.

Other measuring- /switch ranges are available upon request.

MATERIALS

Brass version, wetted parts

| | |
|--------------------------|---|
| Spring: | 1.4571 |
| Gaskets ⁽²⁾ : | NBR (optional FKM, EPDM) ⁽³⁾ |
| Magnets: | Hard ferrite |
| Device body: | Brass, nickel-plated |
| all other wetted parts: | Brass |

Stainless steel version, wetted parts

| | |
|--------------------------|---|
| Spring: | 1.4571 |
| Gaskets ⁽²⁾ : | FKM (optional NBR, EPDM) ⁽³⁾ |
| Magnets: | Hard ferrite |
| Device body: | 1.4571 |
| all other wetted parts: | 1.4571 |

⁽²⁾ Only with process connections

⁽³⁾ Other gasket materials on request



Proudly Distributed By

TRIDENT AUSTRALIA
FLUID SYSTEMS & COMPONENTS

TECHNICAL DRAWING

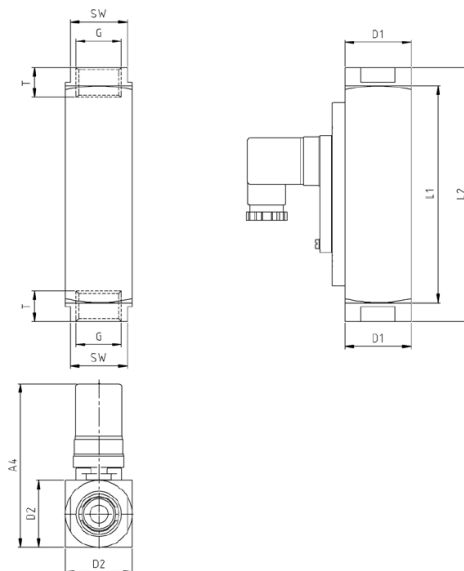

SUMMARY OF TYPES

| Type | Overall dimensions [mm] | | | | | | | | | | | | Weight approx. ca. [g] |
|-------------|-------------------------|----|----|-----|-----|----|----|----|----|----|----|-----|---------------------------|
| | G | DN | SW | L1 | L2 | T | D1 | D2 | A1 | A2 | A3 | A4 | |
| RVM/U-1/30 | 3/4" | 20 | 34 | 130 | 152 | 15 | 40 | 40 | - | - | - | -98 | 1320 |
| | 1" | 25 | 40 | 130 | - | 17 | - | 40 | - | - | - | -98 | 1130 |
| RVM/U-1/45 | 3/4" | 20 | 34 | 130 | 152 | 15 | 40 | 40 | - | - | - | -98 | 1320 |
| | 1" | 25 | 40 | 130 | - | 17 | - | 40 | - | - | - | -98 | 1130 |
| RVM/U-1/60 | 3/4" | 20 | 34 | 130 | 152 | 15 | 40 | 40 | - | - | - | -98 | 1320 |
| | 1" | 25 | 40 | 130 | - | 17 | - | 40 | - | - | - | -98 | 1130 |
| RVM/U-1/90 | 3/4" | 20 | 34 | 130 | 152 | 15 | 40 | 40 | - | - | - | -98 | 1320 |
| | 1" | 25 | 40 | 130 | - | 17 | - | 40 | - | - | - | -98 | 1130 |
| RVM/U-1/150 | 1" | 25 | 40 | 130 | - | 17 | - | 40 | - | - | - | -98 | 1130 |

RVM/U-1 3 0001 12-15 E M



Proudly Distributed By

TRIDENT AUSTRALIA
FLUID SYSTEMS & COMPONENTS

ELECTRICAL DATA

| | |
|---|-----------------------------------|
| Change over (COC) | 250V · 1,5A · 50VA ⁽³⁾ |
| Normally open (NOC) | 250V · 3A · 100VA |
| Change over M12x1 (-20 °C – 85 °C) | 250V · 1,5A · 50VA ⁽³⁾ |
| Normally open M12x1 (-20 °C – 85 °C) | 250V · 3A · 100VA |
| Change over PLC | 250V · 1A · 60VA |

EX-version in compliance with ATEX directive

ATEX II 2 G Ex mb IIC T6 Gb & ATEX II 2 D Ex tb IIIC T80 °C Db
ATEX II 2 G Ex mb IIC T5 Gb & ATEX II 2 D Ex tb IIIC T100 °C Db

| | |
|----------------------|---------------------------------|
| Change over | 250V · 1A · 30VA ⁽³⁾ |
| Normally open | 250V · 2A · 60VA |

UL Recognized switch contacts

| | |
|----------------------|-----------------------------------|
| Change over | 240V · 1,5A · 50VA ⁽³⁾ |
| Normally open | 250V · 3A · 100VA |

⁽³⁾ Minimum load 3VA

ELECTRICAL CONNECTION

- Connector in compliance with EN 175301-803, Form A (DIN 43650, Form A)
- Connector M12x1
- Cable (1 m)

EX-version in compliance with ATEX directive

- Cable (2 m)

UL Recognized switch contacts

- Connector in compliance with EN 175301-803, Form A
- Cable (1 m)

Ingress Protection

IP65: Connector in compliance with EN 175301-803, Form A
IP67: Cable or connector M12x1

Output signal

The contact opens / changes when the flow decreases below the set point.

Power supply

Not required (potential-free reed contacts)

Connector types

Other connector types or cable lengths on request

CONNECTION DIAGRAM

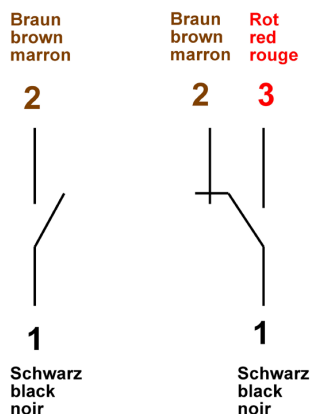

RVM/U-1 4 0003 05-19 E M

Proudly Distributed By

TRIDENT AUSTRALIA
FLUID SYSTEMS & COMPONENTS



MASTERPIECES
MADE IN GERMANY

Meister Strömungstechnik GmbH • Im Gewerbegebiet 2 • 63831 Wiesen / Germany
Tel. +49 (0) 6096 9720-0 • Fax +49 (0) 6096 9720-30 • sales@meister-flow.com • www.meister-flow.com
The general business terms of Meister Strömungstechnik GmbH are valid • All rights reserved



RVM/U-1 5 0001 12-15 EM

Ph: +61 8 9456 1300

Web: www.tridentaustralia.com.au

Email: sales@tridentaustralia.com.au